



Project Title: **Urban Scarring**
 Student Name: **Josh Anderson**

**Honorable
Mention**

Level: **5th**
 Course: **Design Studio**
 Advisor/Instructor: **Michael Hughes**
 Principal Investigator: **Shane Rhymer**
 Department/School: **Department of Architecture, University of Colorado at Denver, Denver, Colorado**

Palate/Medium
 Plans & Sections: Graphite on Vellum
 Perspectives: Adobe Photoshop & **form•Z**
 Model: Hardboard, Steel, & Plexiglas

Summary description of project:

Scarring results from a process of repair, which unites separate parts/pieces, while simultaneously constructing a visible memorial to the rift. Within the realm of urban intervention, scarring presents a new development model capable of revealing both the history of spatial separation and the process of repair. To begin this process of scarring, a suture is needed as an initial cohesive element. The suture is a foreign intervention and temporary connective device, which enables reconstruction over a period of time.

The site, a series of fragments loosely connected by the linear park system located along Cherry Creek in Lower Downtown Denver, lacks any substantial spatial connection to the surrounding urban landscape. The suture was used as a conceptual and formal device in an attempt to reconnect these separated spaces back into the life of the city while creating a distinct and alternative urban experience. The suture, in the form of a coherent program consisting of cultural and entertainment venues, enables these separate sites to be linked/unified through a series of event spaces to be implemented over time. This insertion of these new event spaces acknowledges the complex sectional quality of the site and weaves new points of connection between the existing pedestrian pathways at street level in Lower Downtown and the lower level of recreational activity (parks, bike paths, and open spaces) existing below street level along the Cherry Creek corridor.

The first event program deployed, and the focus of this project at the architectural scale, will be a new Museum of Contemporary Art.

Jury Comments:

A very clear and understandable project even if not an easy one to connect all these parts of an existing landscape. The project is so evident that I would really like to see the scaled model. This project is mixing architecture and Urban Design...very good integration!

The modeling in **form•Z** is nothing complicated but very well mastered. The grayscale pers. (as well as pictures of the scaled model) views are not only very well made but add to the simplicity of the design and lead to the essential comprehension for all. A really good and realistic project.

•Christian Allebosch

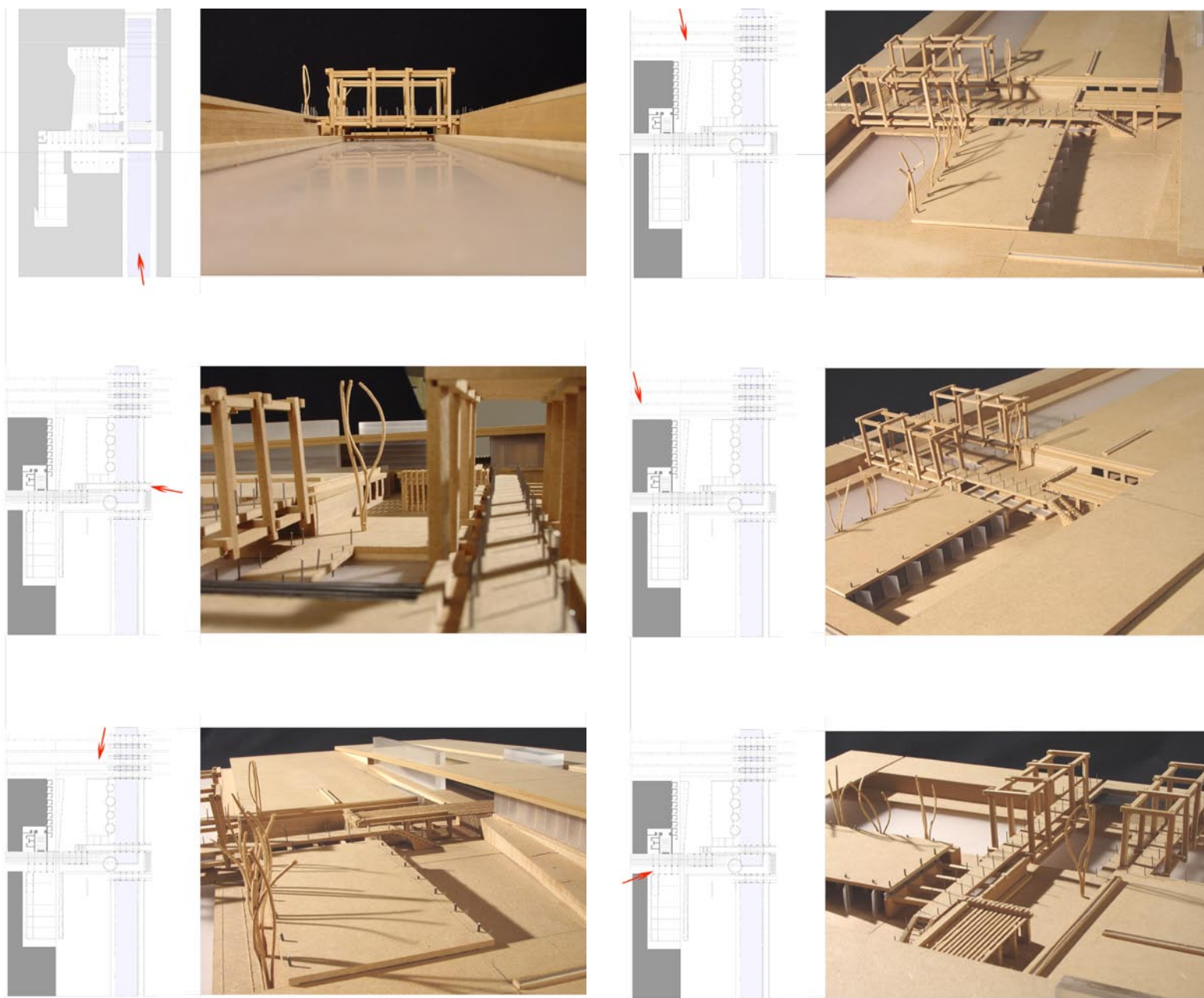

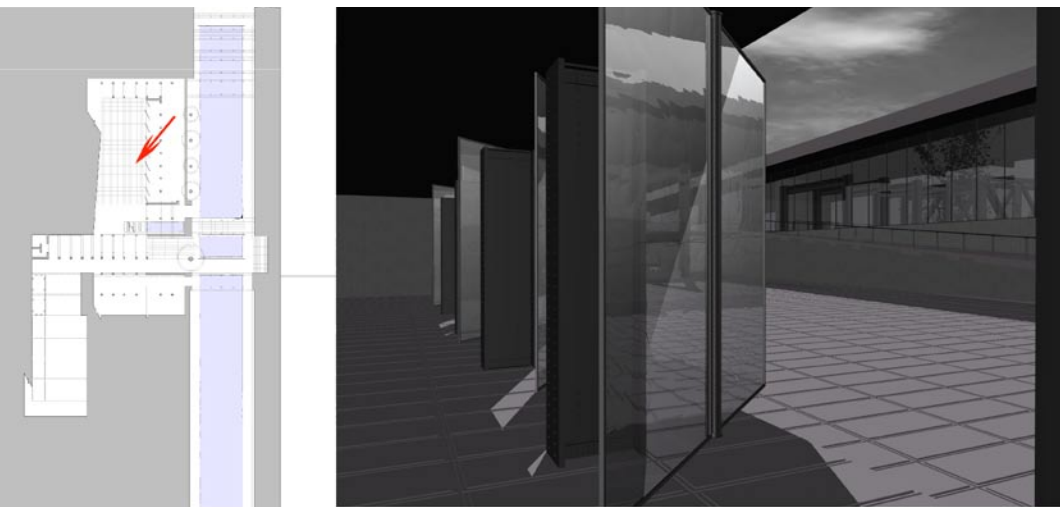

View outward from secondary gallery

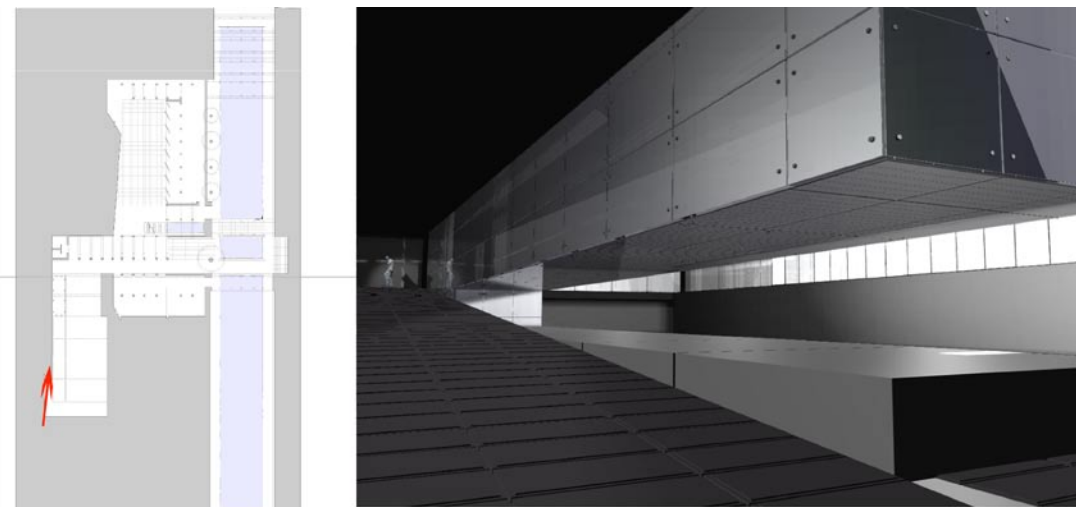

View from main gallery towards upper floor

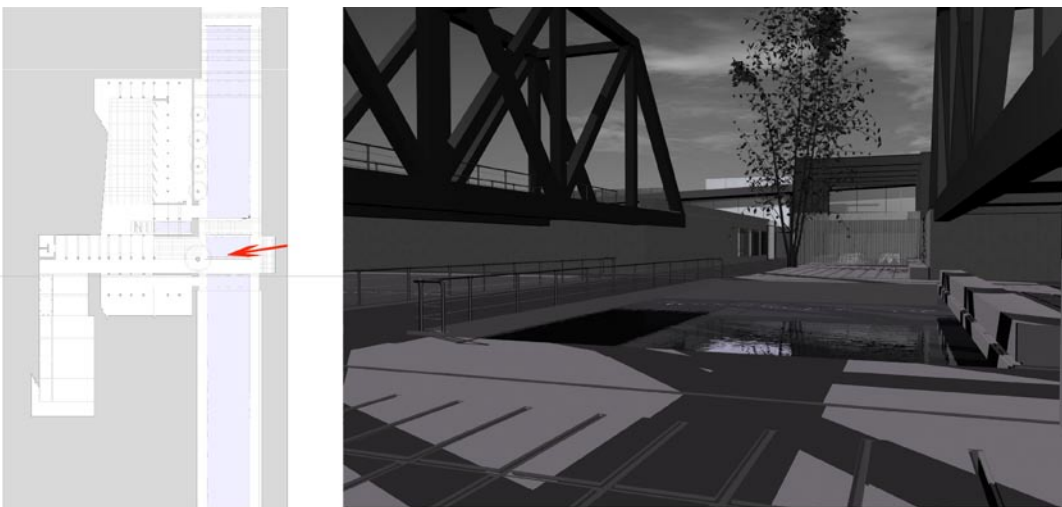

View from lower entry courtyard

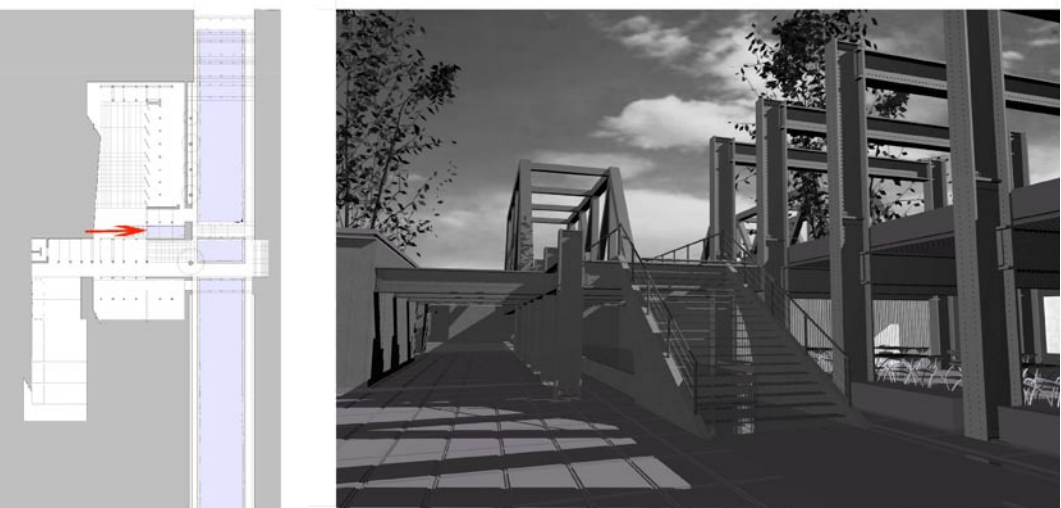

View from inner courtyard towards creek

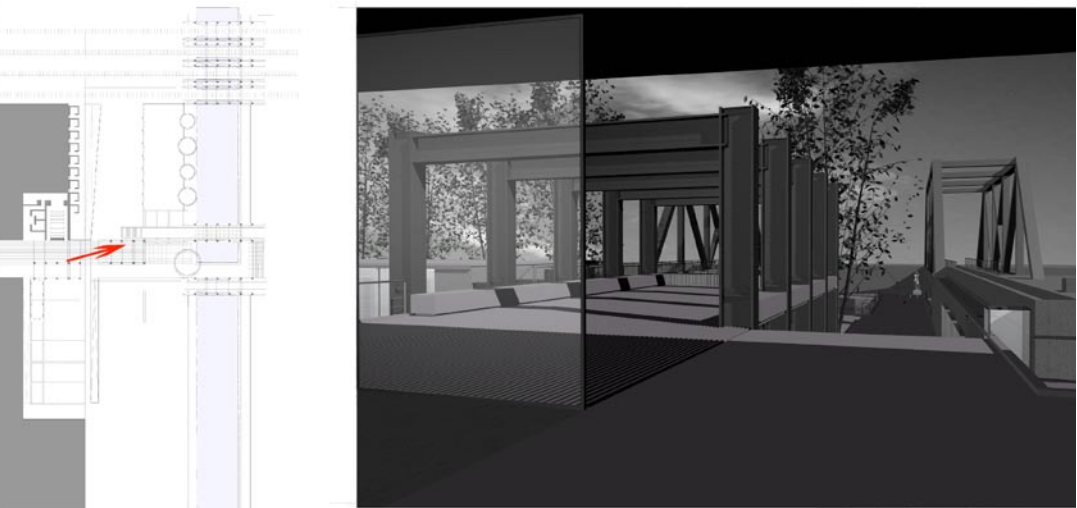

View from pathway under speer boulevard towards creek



View outward from bookstore/coffee shop

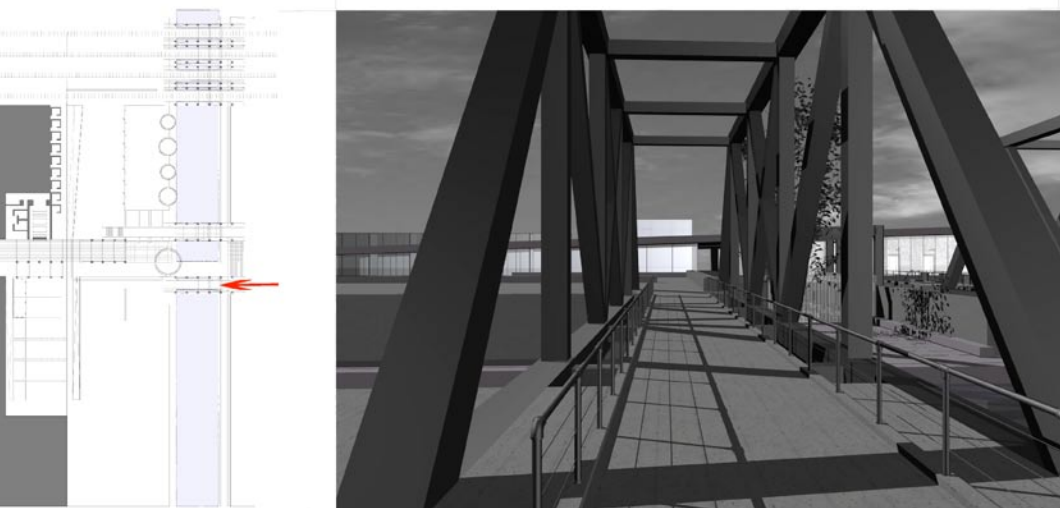

View from upper entry



View from underneath existing railway

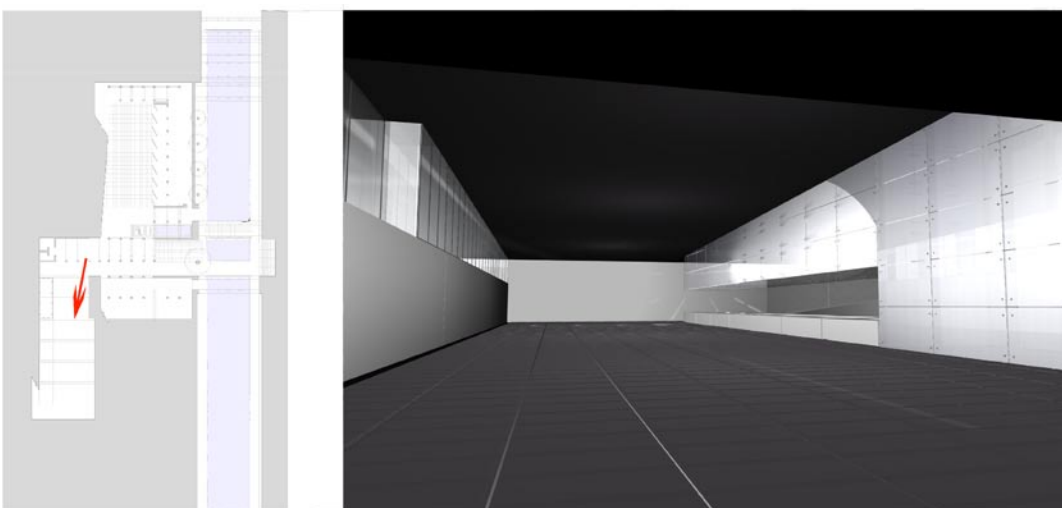

View from inside main gallery

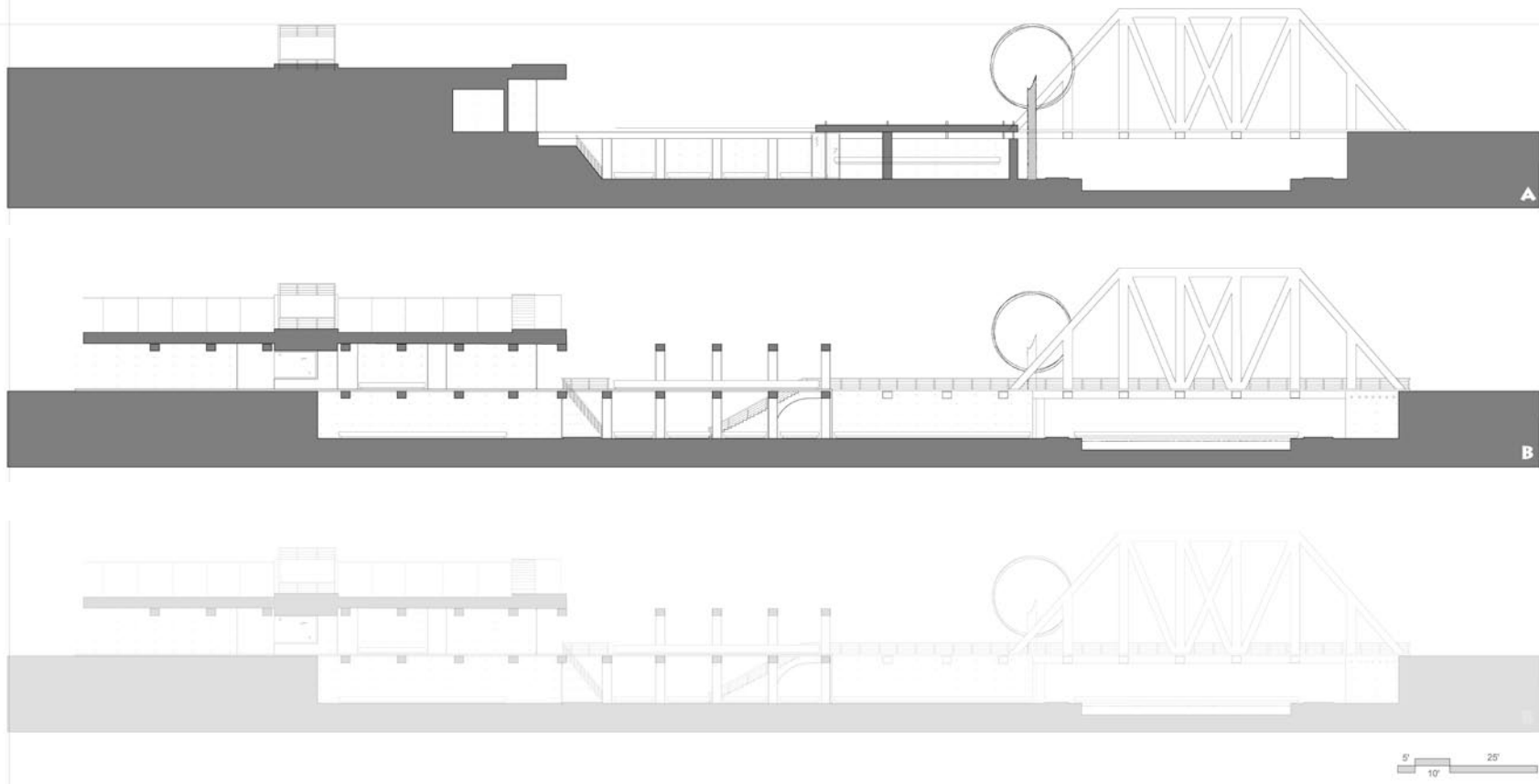

Reasons for the nomination:

Throughout the project **form•Z** was used extensively to model, explore, and represent the spatial complexity of both the given urban context and the proposed architectural intervention. Modeling the site in **form•Z** at the beginning allowed the design process to evolve from the perspective of experiential inhabitation. This focus on designing from the inside or, more specifically, from the occupant's point of view, enabled the student to engage a subtle exploration of light and texture as a method for integrating architecture into the urban landscape.



SITE SEPARATION

CURRENTLY THE SITE IS DIVIDED INTO FOUR FRAGMENTED PIECES, WHICH RUN ALONG CHERRY CREEK AND TERMINATE AT THE PLATTE RIVER TO THE NORTH. ANOTHER LAYERING OF PROGRAM AND EVENT, IS NEEDED IN ORDER TO BEGIN DEVELOPING AN URBAN SUBCULTURE WHICH WILL THRIVE AND GIVE RISE TO AN INDIVIDUALIZED IDENTITY WITHIN THE GIVEN URBAN CONTEXT.



EXISTING PATHWAYS

€
BROKEN INFRASTRUCTURE

WHILE CREATING A NEW URBAN IDENTITY WITHIN A SITE IT IS CRUCIAL THAT THE INSERTION POINTS CONNECT TO THE CITY'S EXISTING PATHWAYS, HOWEVER INSTEAD OF DISCARDING, OR IGNORING THE HISTORICAL INFRASTRUCTURE OF THE SITE, THIS PROJECT WILL EMBRACE IT UTILIZE THE OPPORTUNITY THAT IT PROVIDES. THUS THESE FIVE POINTS WILL BECOME THE INSERTION POINTS FOR A SERIES OF HIGHLY PROGRAMMED EVENTS, THE FIRST ONE BEING THE THE DENVER MUSEUM OF CONTEMPORARY ART.

EVENT INSERTION

A SERIES OF FIVE EVENTS WILL BE IMPLEMENTED OVER A TIME SPAN OF TEN YEARS. EACH OF THESE EVENTS WILL REQUIRE MULTIPLE MEANS OF ACTIVATION, WHICH WILL HELP CREATE THE MUCH NEEDED IDENTITY THAT IS CURRENTLY LACKING.

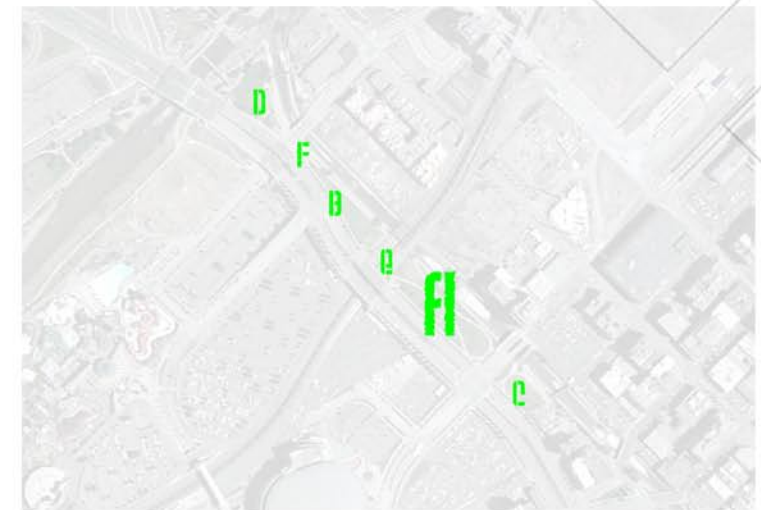

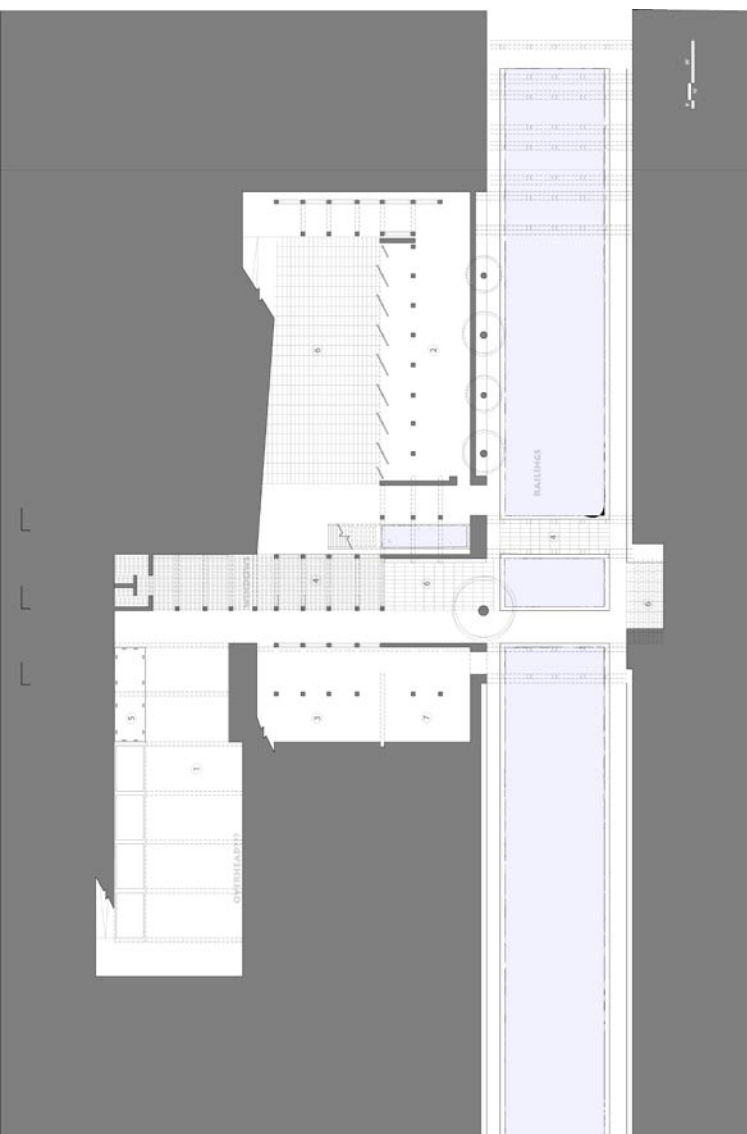

LOWER-FLOOR PLAN
SCALE 1/64" = 1'

A
B
C

1. Main Gallery
2. Secondary Gallery
3. Auditorium
4. Staircase
5. Mechanical Room
6. Courtyard
7. Lobby
8. Office
9. Restroom
10. Elevator

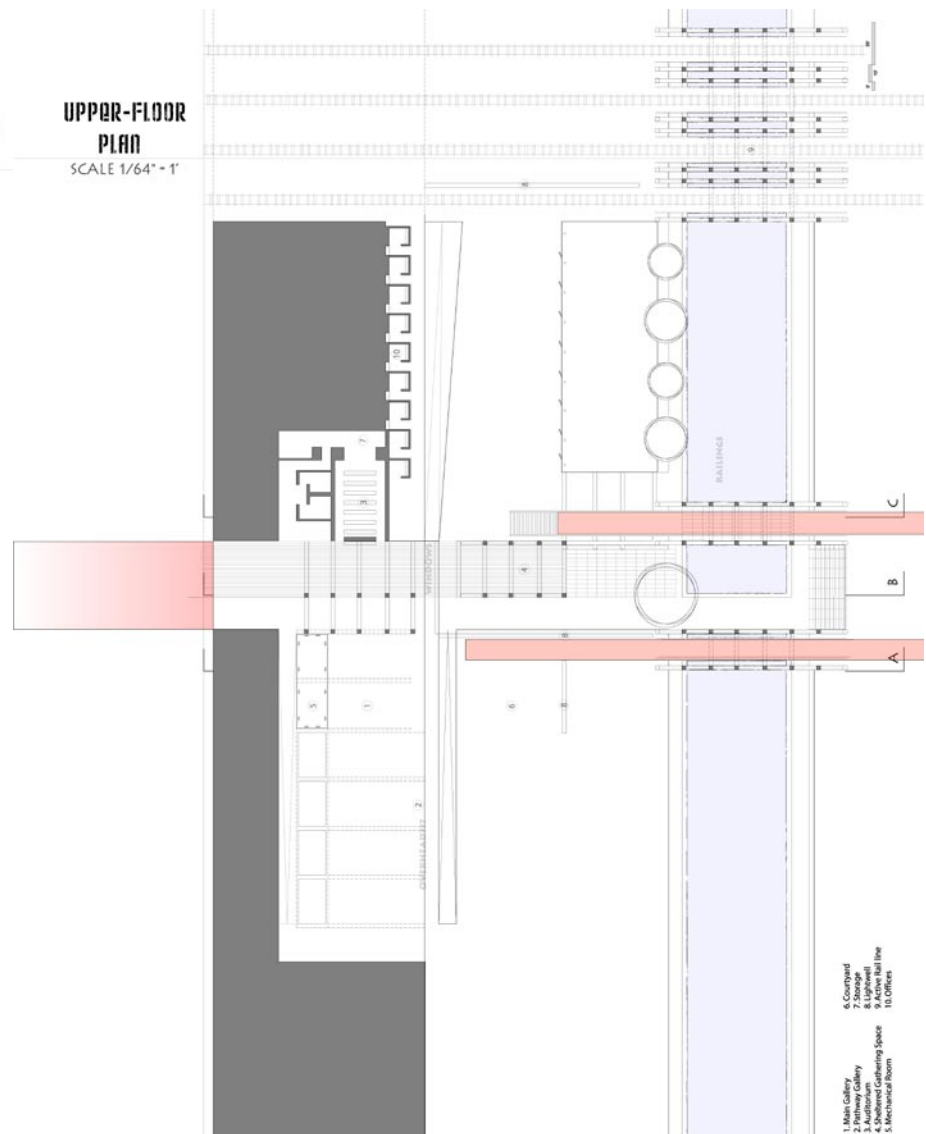

UPPER-FLOOR PLAN
SCALE 1/64" = 1'

1. Main Gallery
2. Secondary Gallery
3. Auditorium
4. Staircase
5. Mechanical Room
6. Courtyard
7. Lobby
8. Office
9. Restroom
10. Elevator

ROOF PLAN
SCALE 1/64" = 1'

