



**Honorable
Mention**

Project Title: **Space/Time Museum**
Student name: **Steven Purvis**
Level: **Fifth Year**
Course: **Terminal Studio**
Advisor/Instructor: **Kevin Nute**
Principal Investigator: **Glenn Wilcox**
Department/School: **Department of Architecture,
University of Oregon, Eugene, Oregon**

Summary description of project:

Design for a Space/Time museum in Greenwich, England. Sited directly on the Prime Meridian, the premise for the project was a juxtaposition between two ordered systems representing different interpretations of space and time. Program elements of gallery, auditorium, cafe, work-shops, etc.

Reasons for the nomination:

Extensive use of **form•Z** throughout the design process. Intricacy and completeness of final model. Use of more complex skinning and lofting functions demonstrates command of software. Final presentation composed as an illustration of project - rather than a series of renderings.

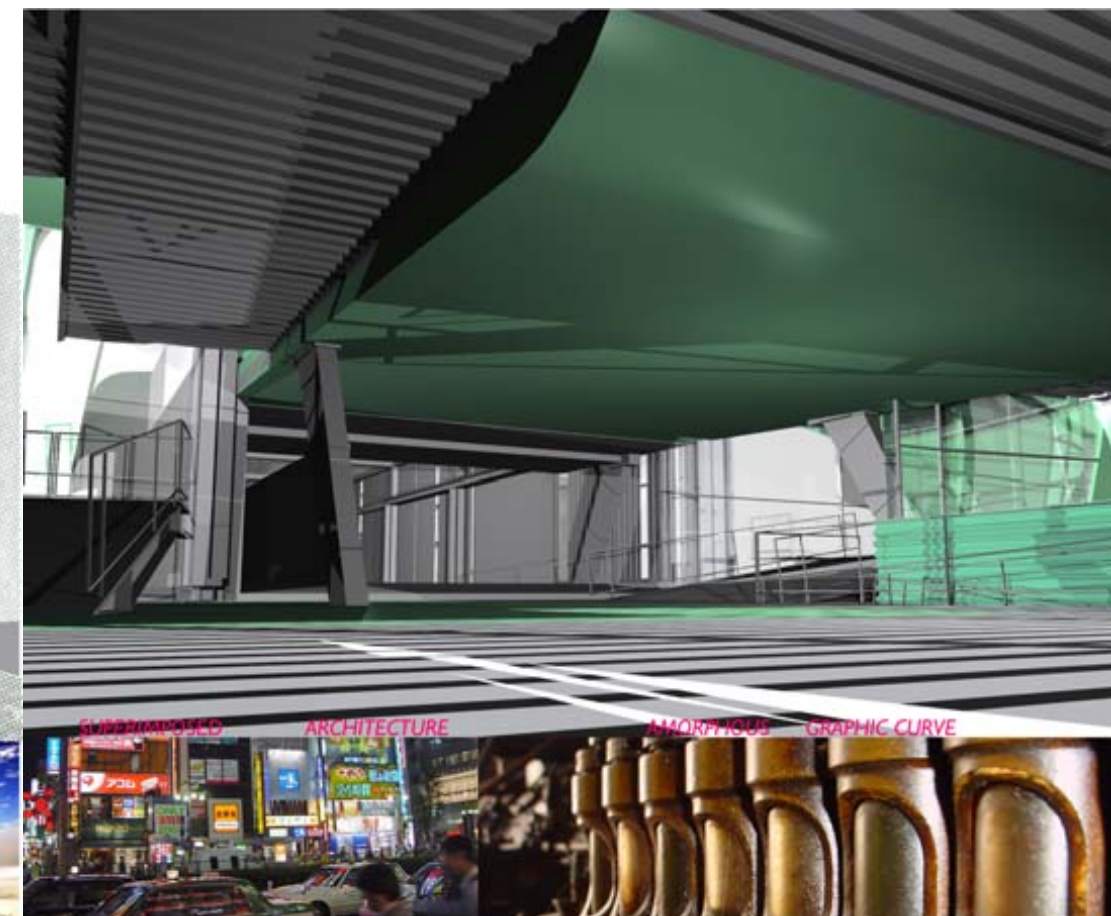
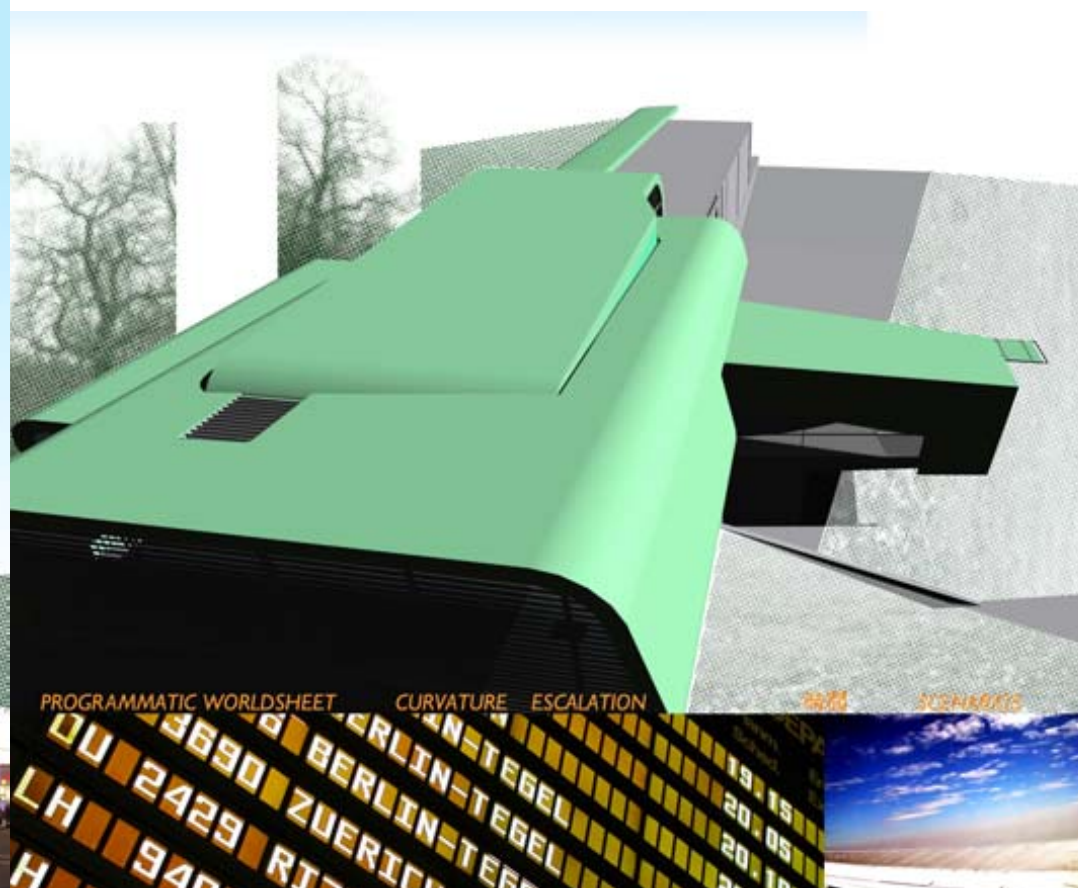

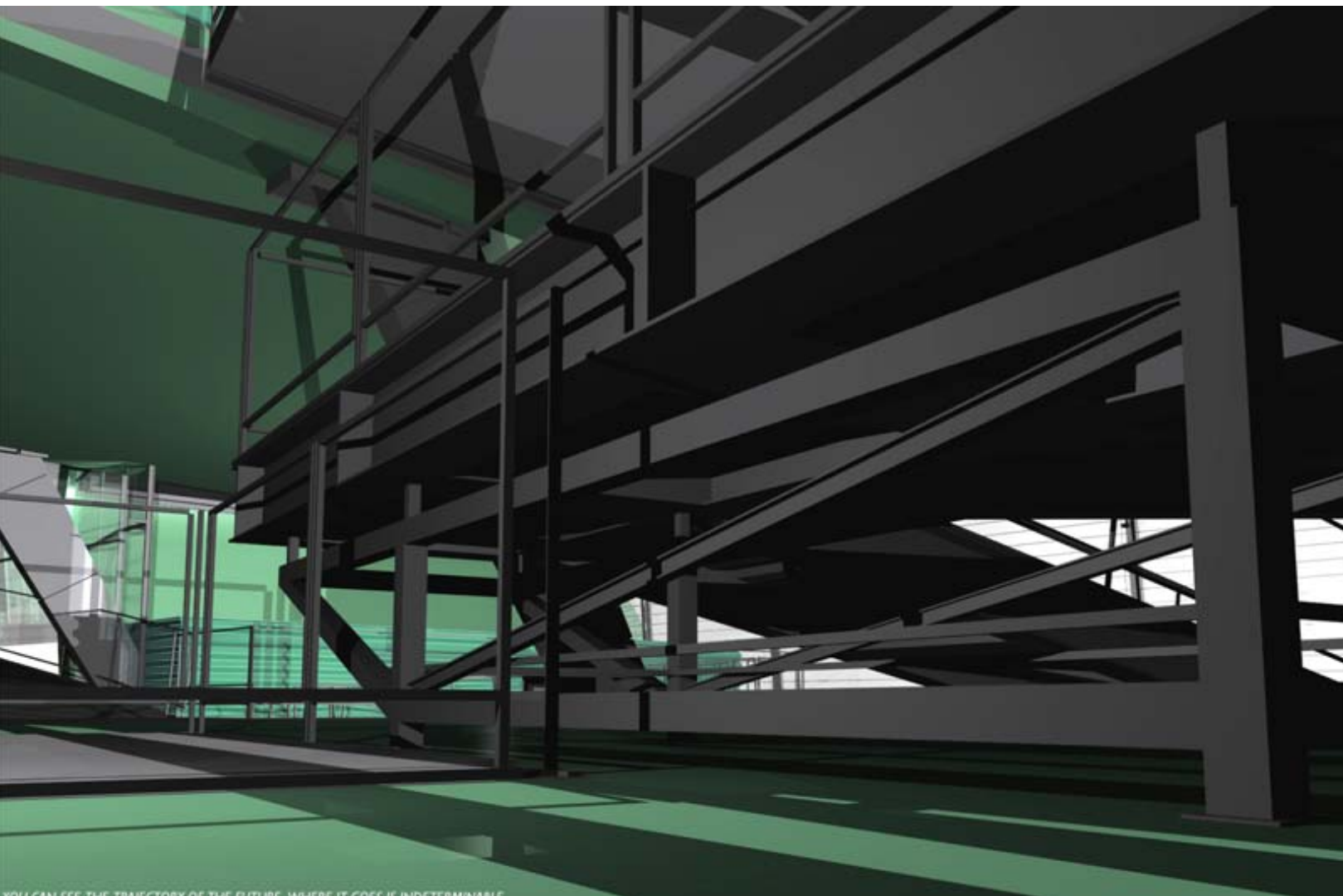

Jury Comments:

The project excels for comprehensiveness of detail and clarity of design intent. Command of modeling skills and lighting values is evident in the modulation of the glass in the interior perspective.

• **Pierluigi Serraino**

